

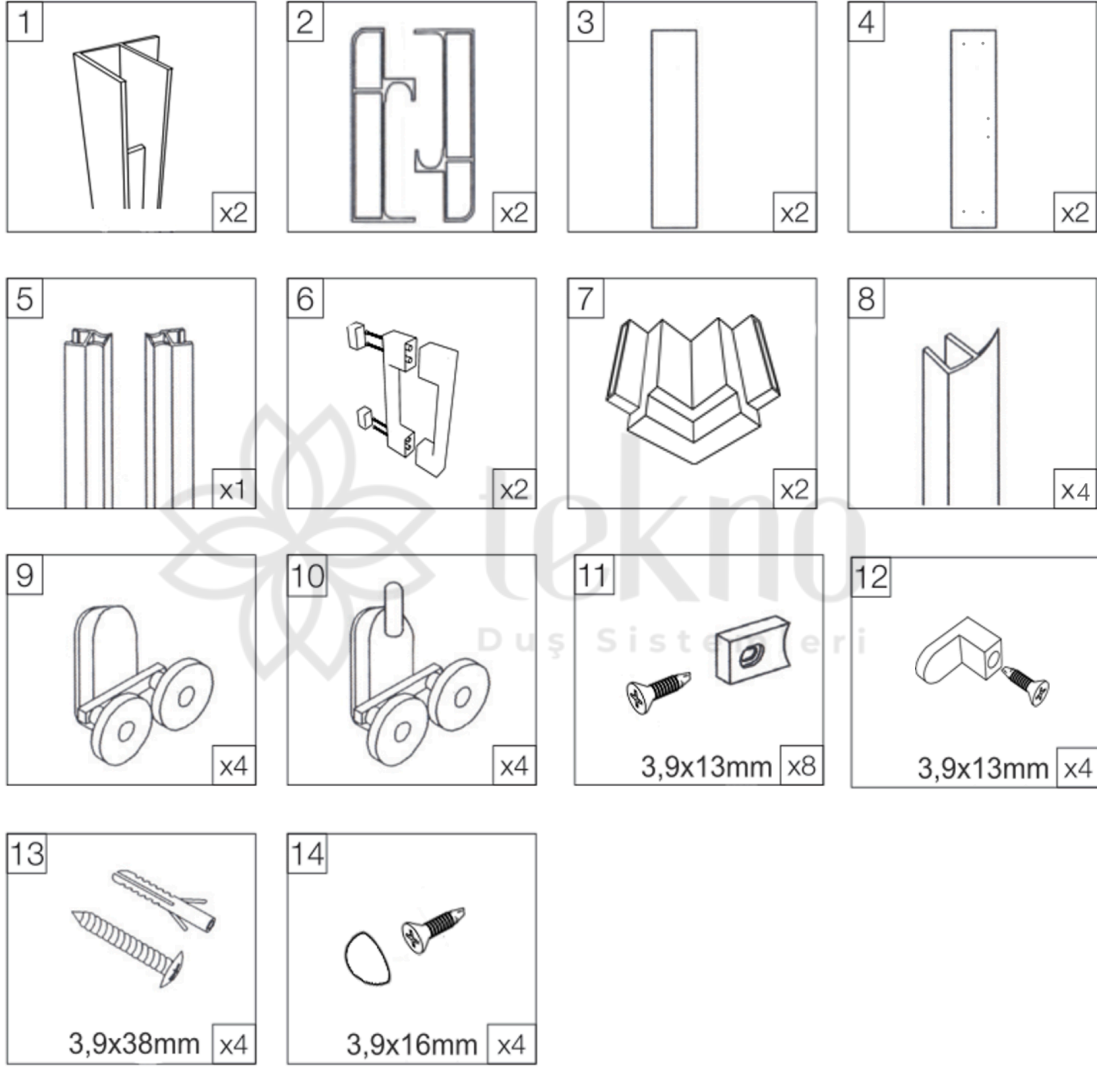

## MONTAJ TALİMATI

### Köşe Duşakabin





1 - Duvar Profili

2 - Ray Profili

3 - Sabit Cam

4 - Kapı Camı

5 - Mıknatıslı Fital

6 - Kulplar

7 - Köşe Takoza

8 - Suluk Fitali

9 - Üst Rulman

10 - Alt Rulman

11 - Rulman Stoperi

12 - Sabit cam tutucu

13 - Dübel ve duvar vidası

14 - Profil vidası

ve vidası

ve vidası

ve başlığı

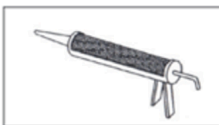

Silikon

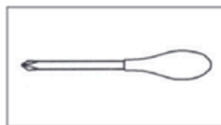

Tornavida

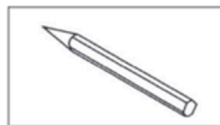

Kalem



Matkap



Elektrikli Tornavida

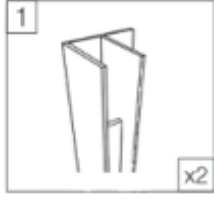

Duvar profili

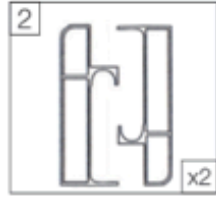

Raylar



Dübel ve duvar vidası



Kalem



Matkap

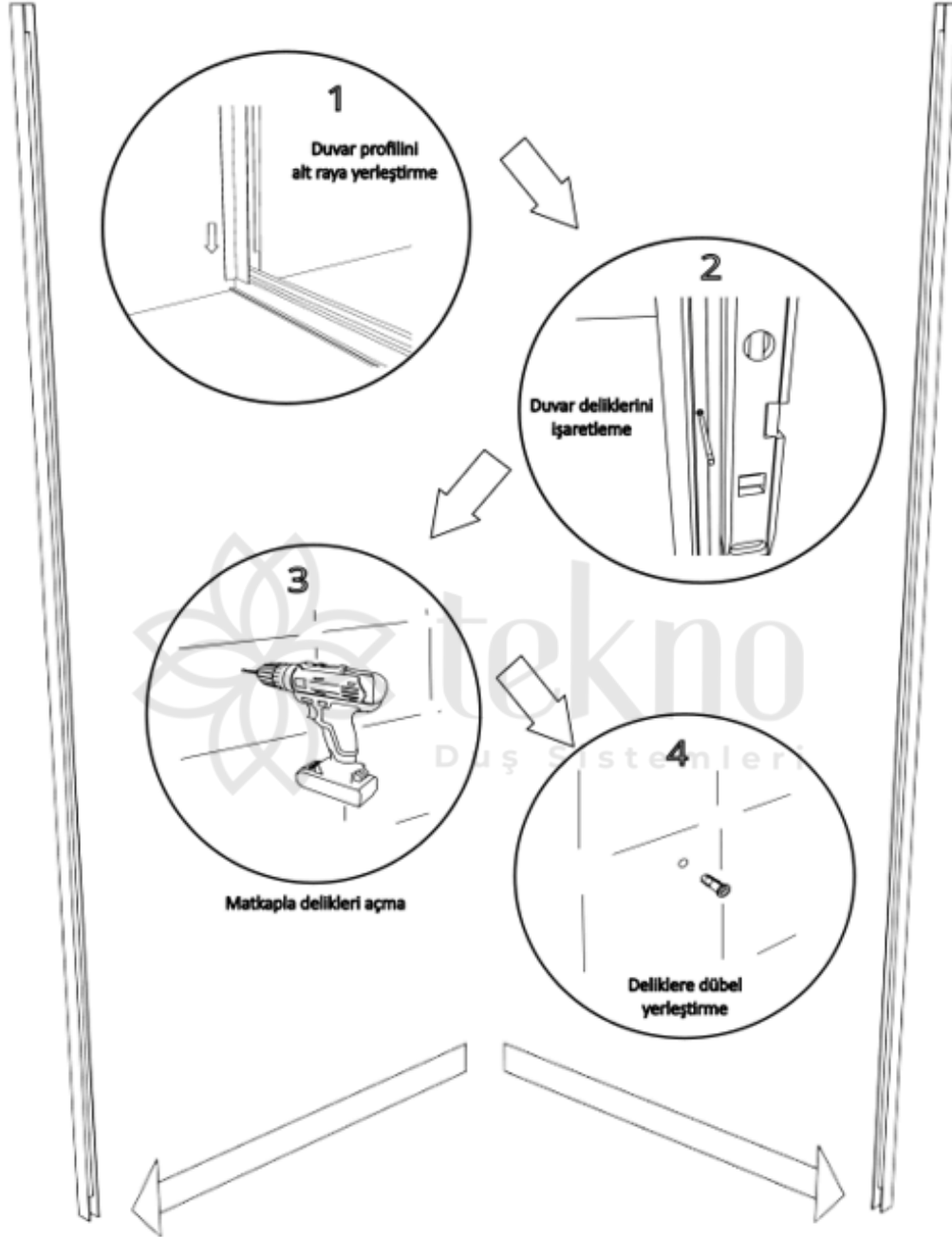

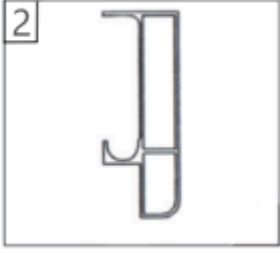

Üst Ray

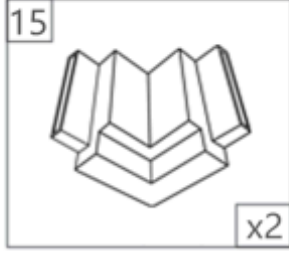

Köşe Takoğu

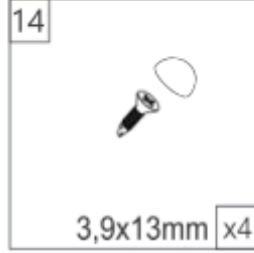

Profil vidası  
ve başlığı



Elektrikli tornavida

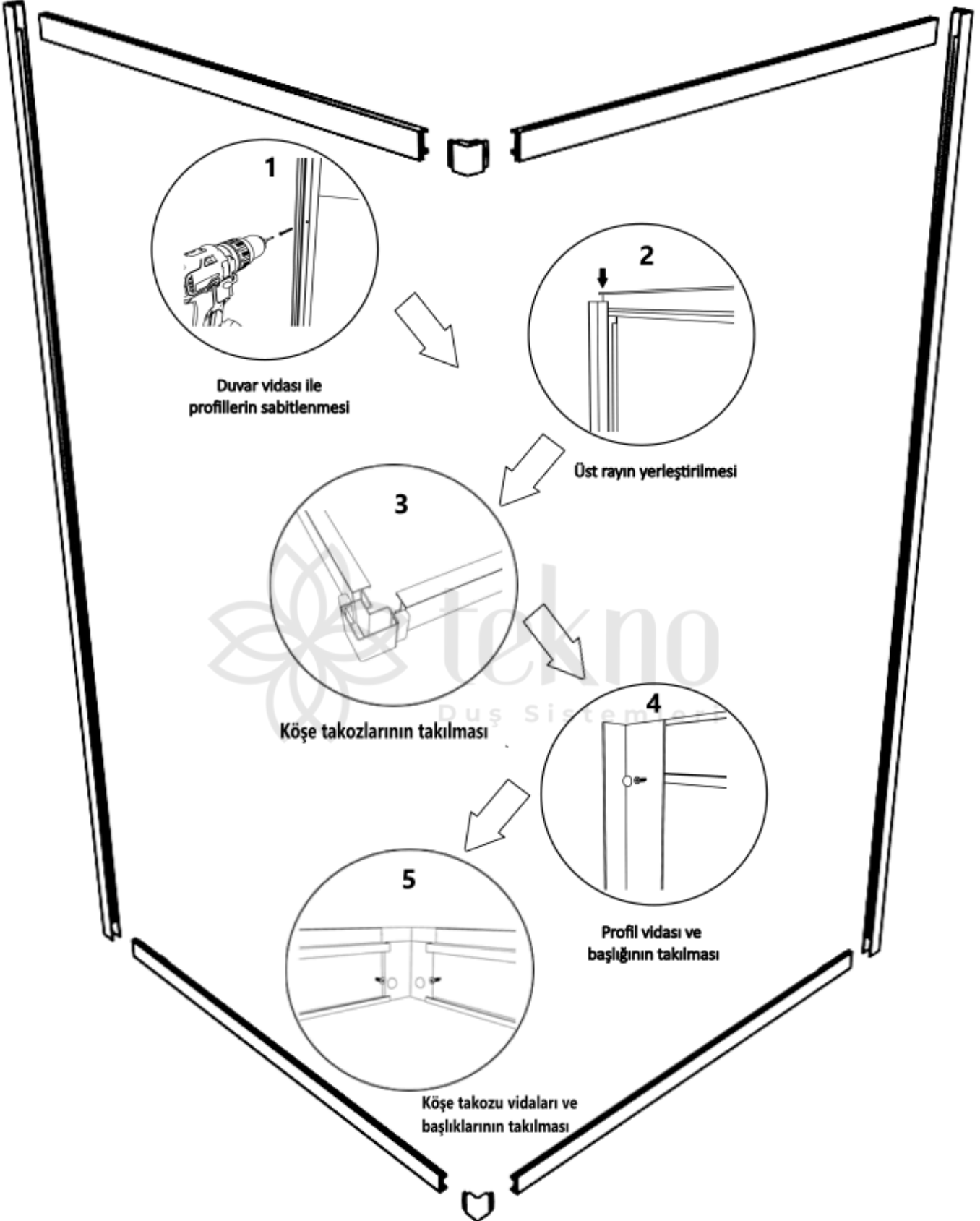

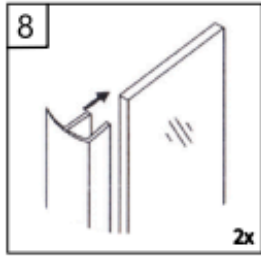

Suluk

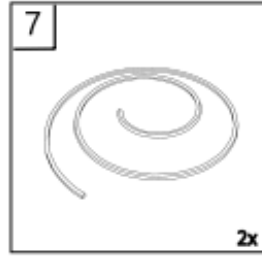

Fitul

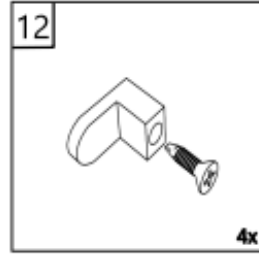

Cam tutucu ve vidası

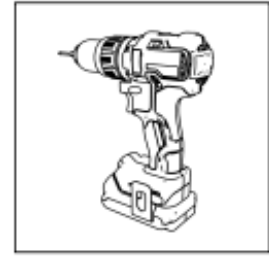

Elektrikli tornavida

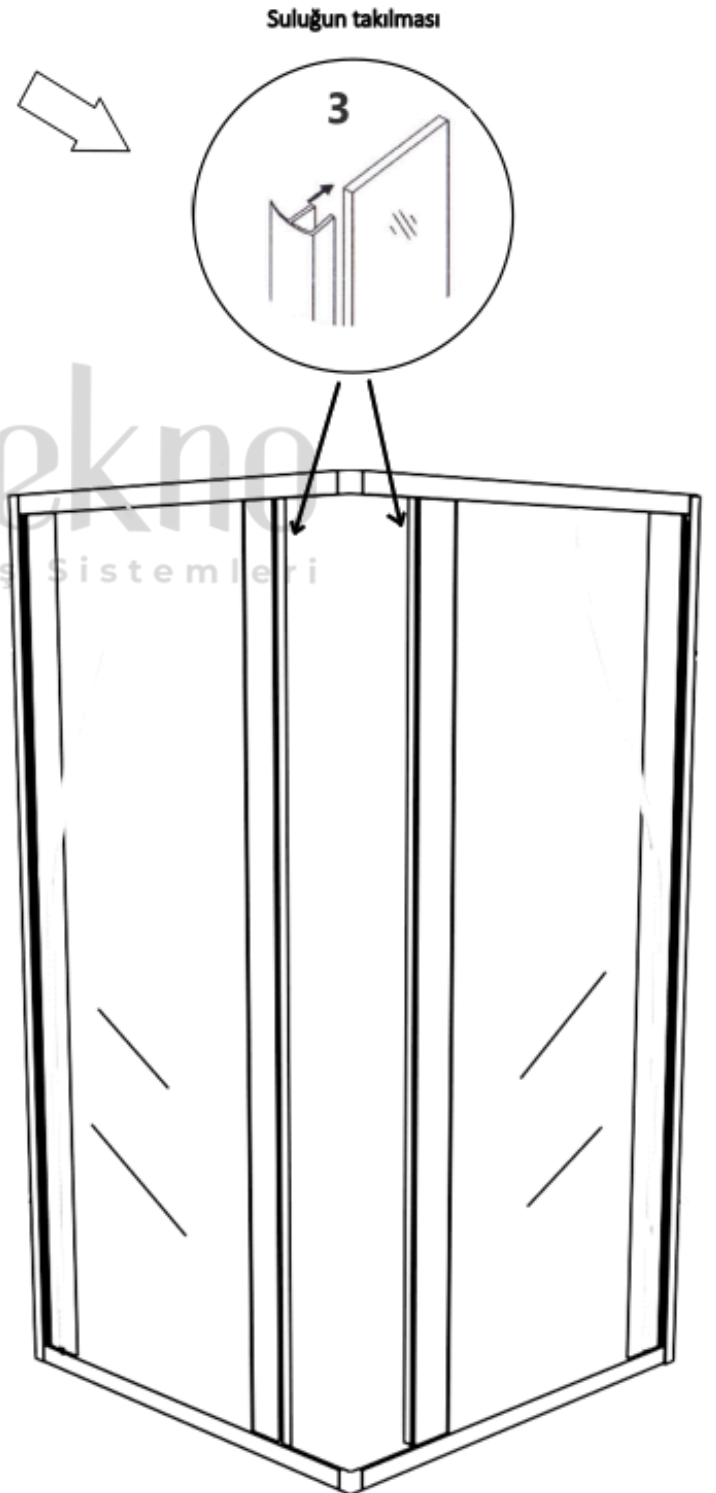
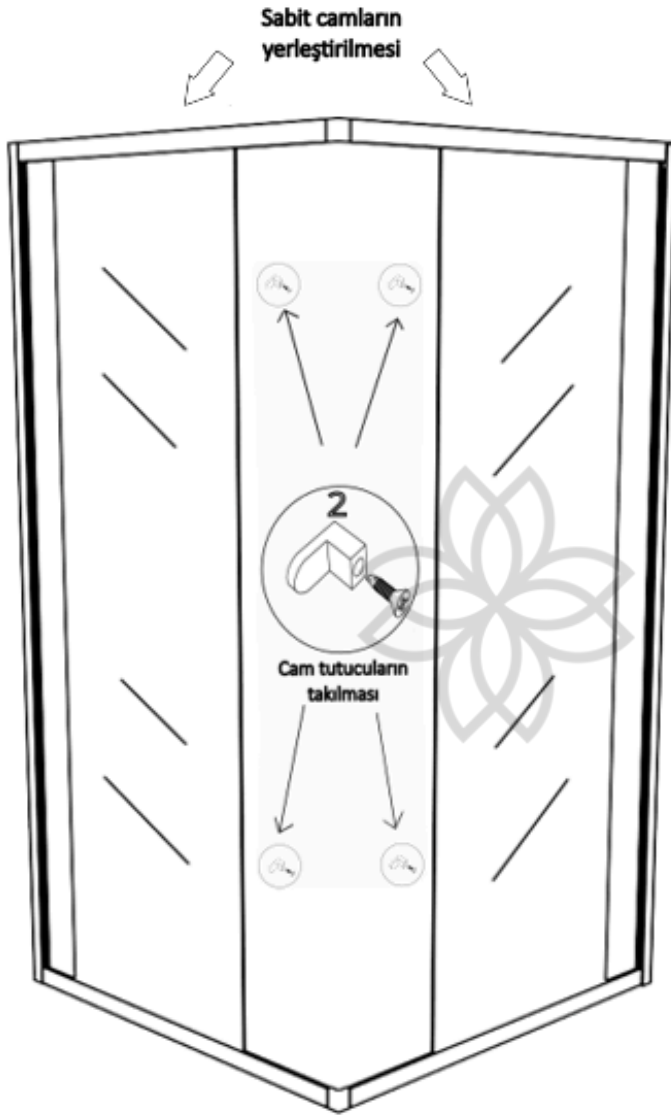

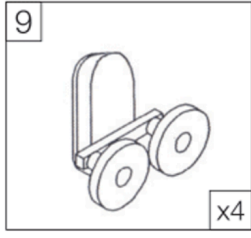

Üst Rulman

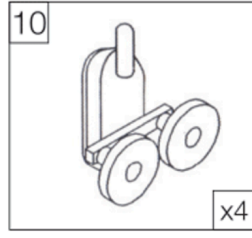

Alt Rulman

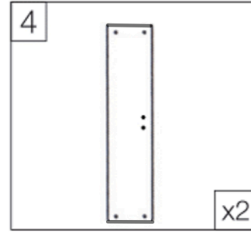

Kapı Camı

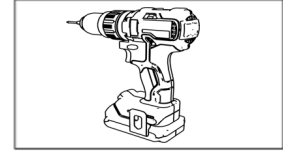

Elektrikli Tornavida

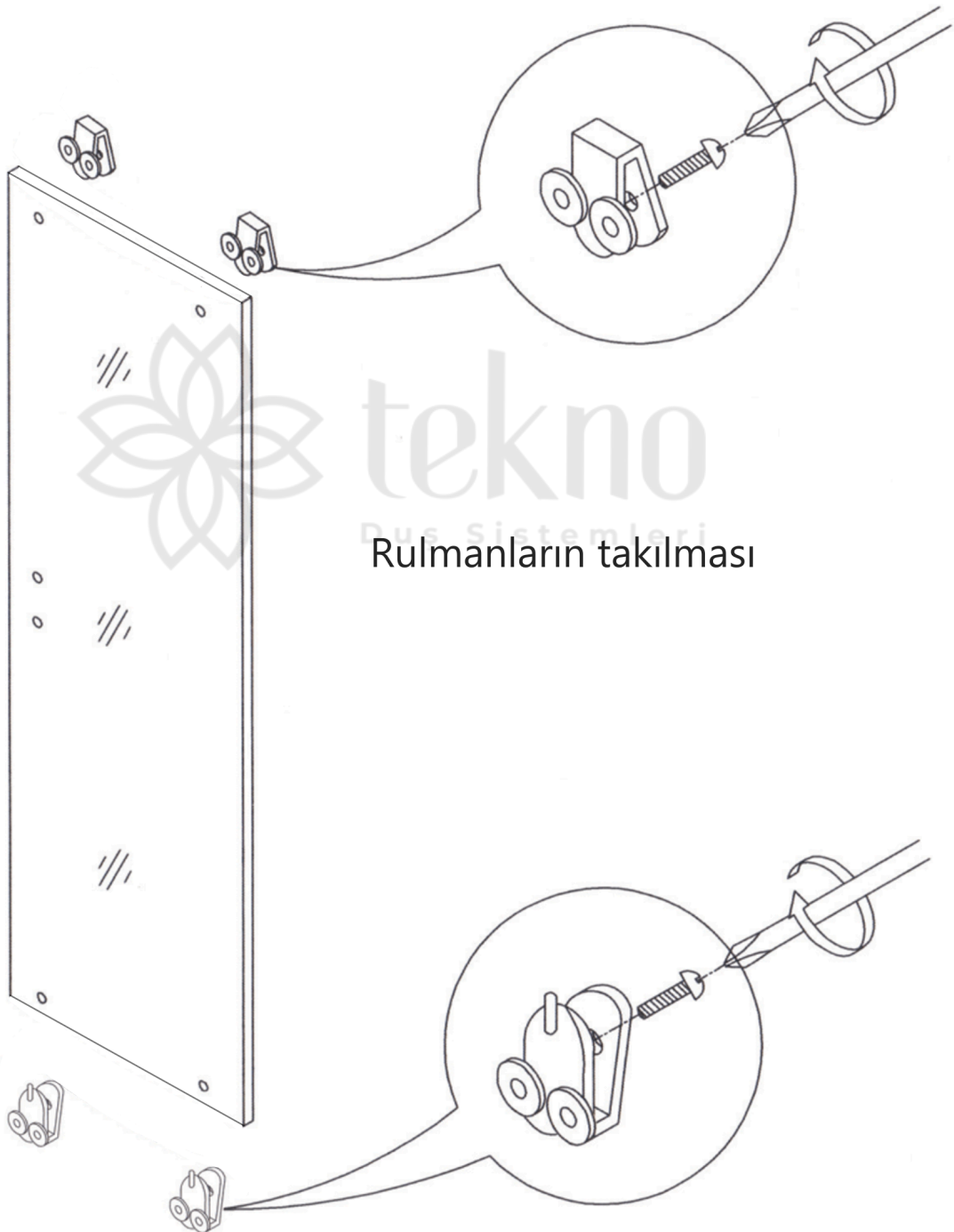

Rulmanların takılması

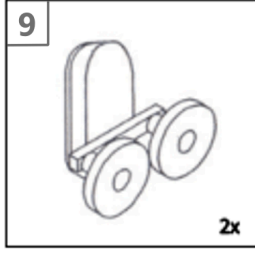

Üst rulman

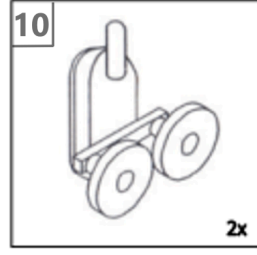

Alt rulman

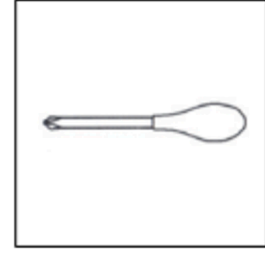

Tornavida

Önce üst rulmanın  
tekerleri yukarı kaldırılır

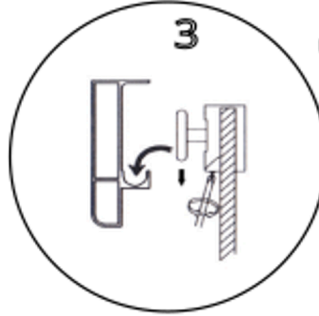
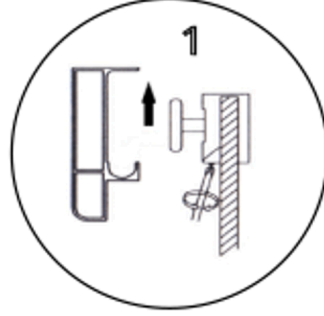

Üst rulmanın tekerleri  
raya oturtulur

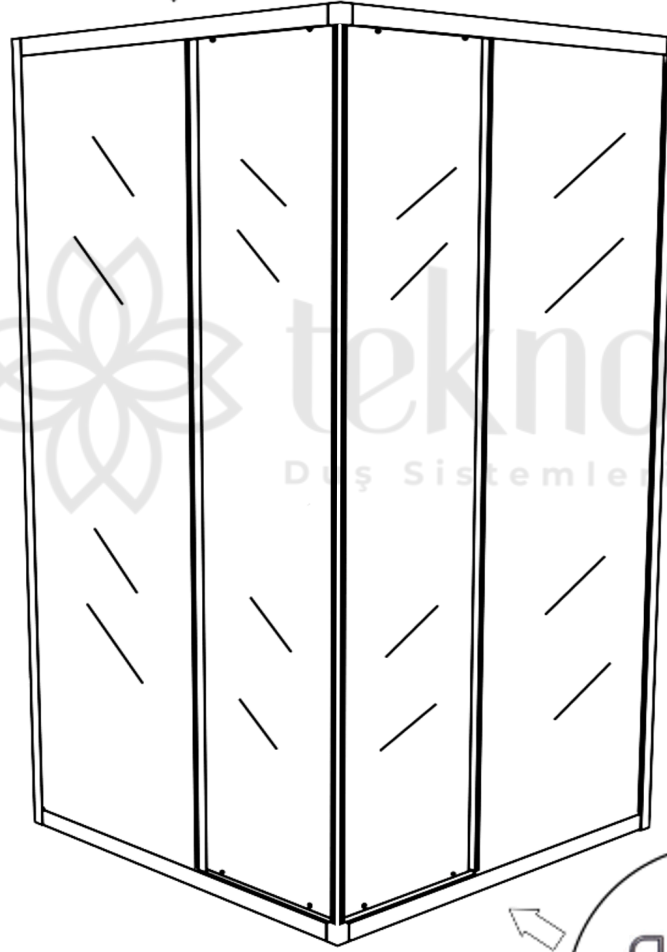

Alt rulmanın çubuğuna  
parmakla basılarak  
tekerler rayaya yerleştirilir

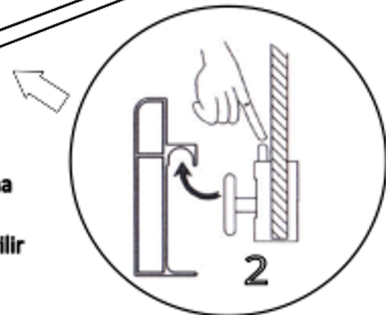

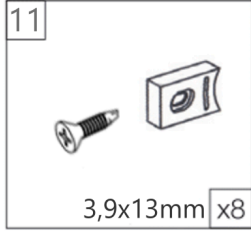

Stoper ve vidası

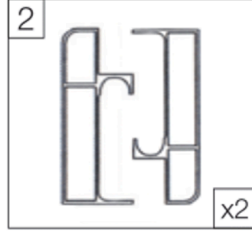

Raylar

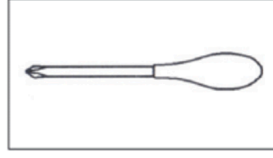

Tornavida

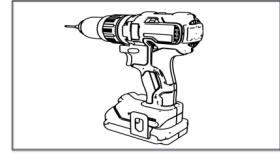

Elektrikli Tornavida

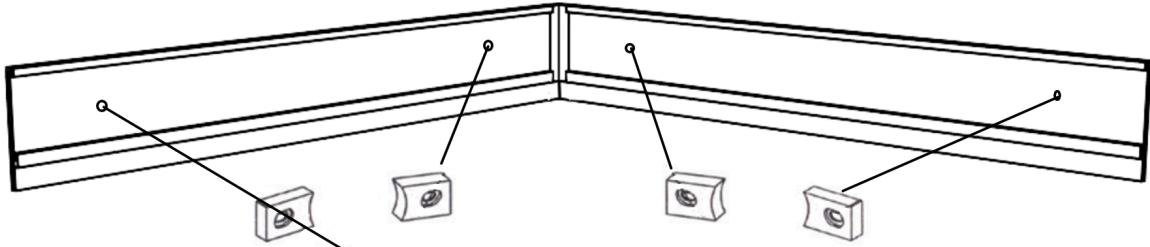

Stoperlerin Takılması

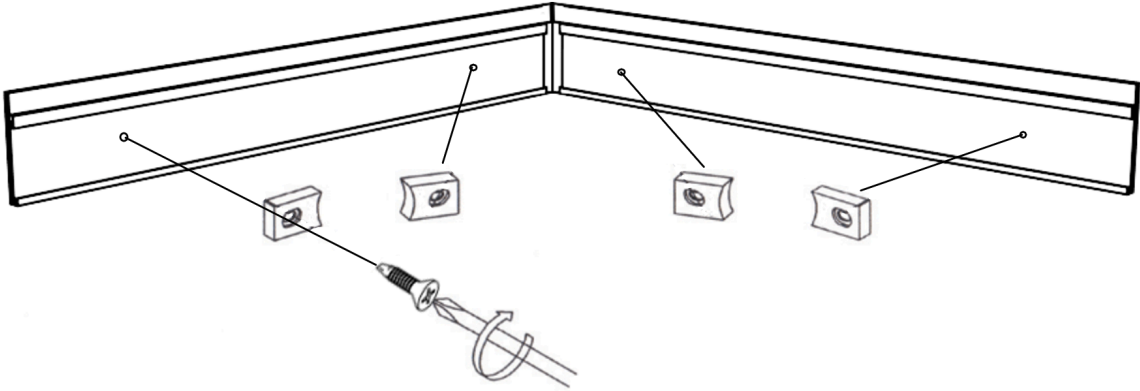



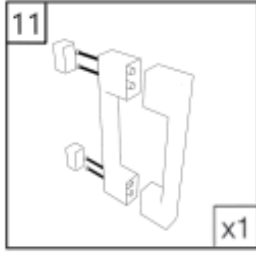

Kulpar

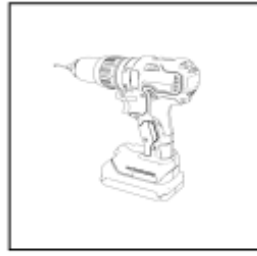

Elektrikli torna

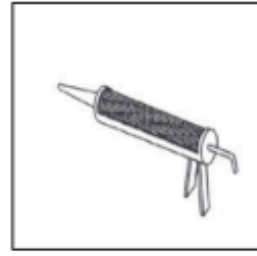

Silikon

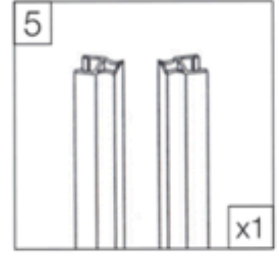

Mıknatıslı fitiller



Mıknatıslı fitillerin  
takılması

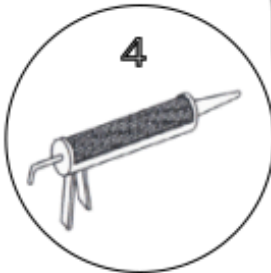

Duvar-profil arasına  
silikon çekme

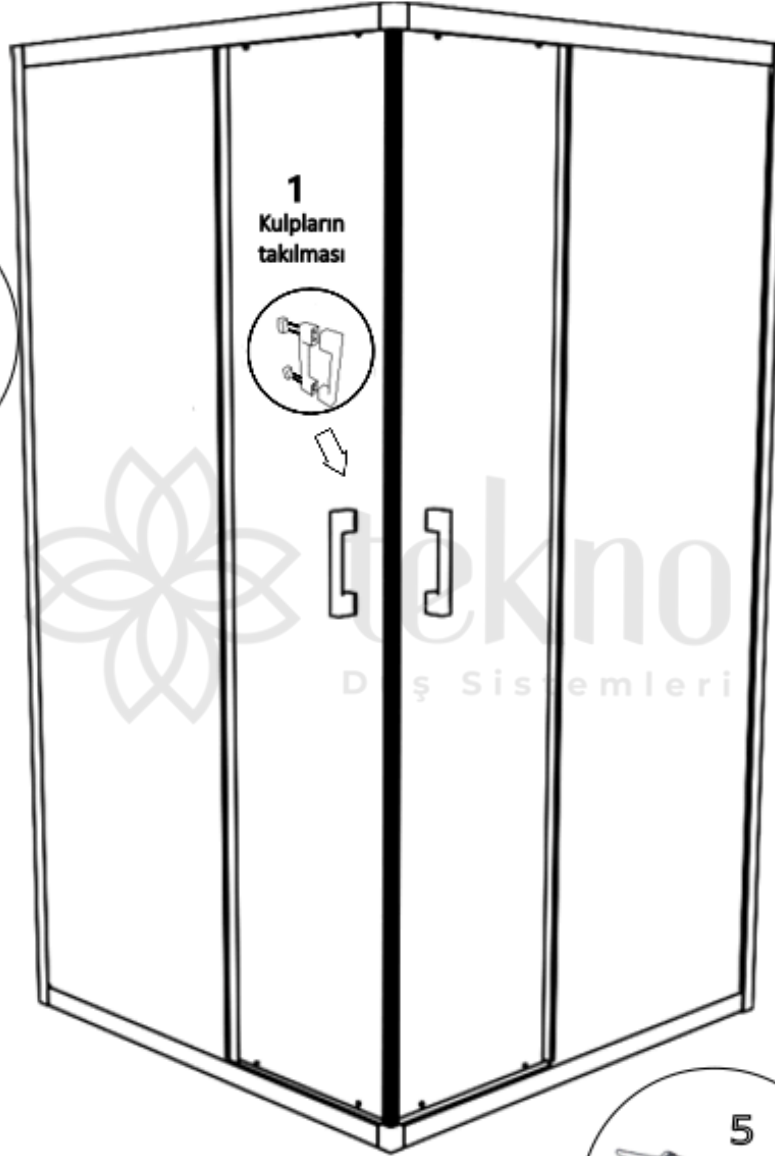

1  
Kulpların  
takılması

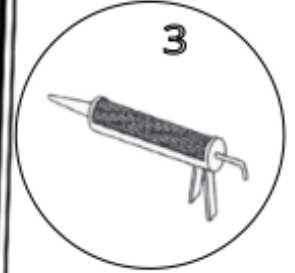

Duvar-profil arasına  
silikon çekme

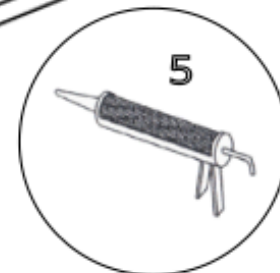

Duvar-profil arasına  
silikon çekme



**tekno**  
Duş Sistemleri