

**MONTAJ ŞEMASI
(MOUNTING DIAGRAM)**

1	PLASTİK KAVELA (PLASTIC COVER)		14 Ad
2	MİNİFİKS GÖVDESİ (MINIFIX BODY)		14 Ad
3	DÜBELLİ MİL (SHAFT WITH PEG)		14 Ad
4	MİNİFİKS TIPASI (MINIFIX PLUG)		14 Ad
5	PLASTİK DÜBEL (PLASTIC PEG)		2 Ad
6	VİDA YHB 4x18 (SCREW YHB 4x18)		20 Ad
7	VİDA YHB 6x70 (SCREW YHB 6x70)		2 Ad
8	ASKI ELEMANI (HANGER COMPONENT)		1 TK
9	MENTEŞE (HINGE)		4 Ad
10	RAF PİMİ (SHELF PIN)		8 Ad
11	BACK PİMİ (BACK PIN)		8 Ad
12	VİDA YHB 3x18 (SCREW YHB 3x18)		8 Ad

NOT: AKSESUAR (KULP, RAY VB.) GENEL GÖRÜNÜM AMAÇLI OLUP KATALOG GÖRÜNÜMÜNDEN FARKLI OLABİLİR.
(NOTE: ACCESSORY (HANDLE,RAİL,ETC.) IS FOR GENERAL VIEW AND MAY DIFFER FROM CATALOG VIEW)

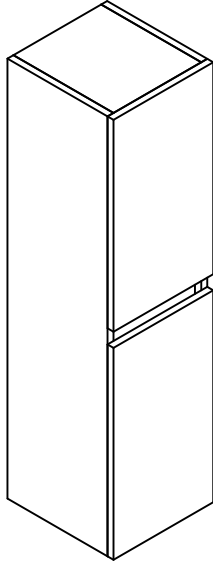
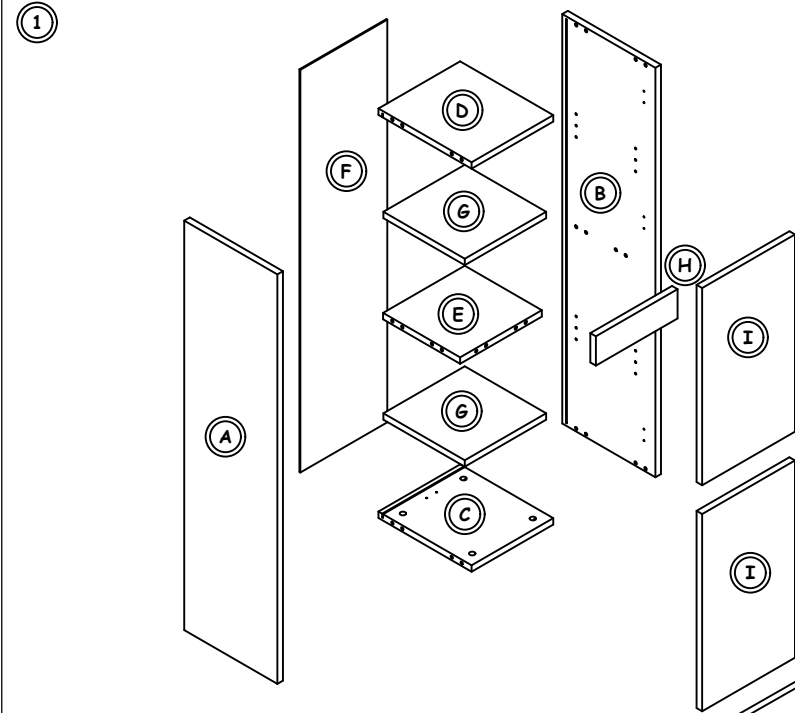

A	SOL YAN TABLA (LEFT SIDE PLATE)	1	ADET
B	SAĞ YAN TABLA (RIGHT SIDE PLATE)	1	ADET
C	ALT TABLA (LOWER PLATE)	1	ADET
D	ÜST TABLA (TOP PLATE)	1	ADET
E	ORTA BÖLME (MIDDLE SECTION)	1	ADET
F	ARKALIK (BACKBOARD)	1	ADET
G	RAF (SHELF)	2	ADET
H	ARA KAYIT (MIDDLE HORIZONTAL BAR)	1	ADET
I	KAPAK (DOOR)	2	ADET

②

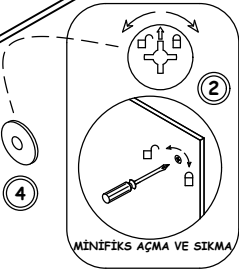

ÖNCE YAN TABLANIN BİRİNİN MONTAJINI YAPINIZ VE SONRASINDA ARKALIĞI KANALA OTURTARAK TAKINIZ.
(BEFORE ASSEMBLING THE CABINET, THE HANGER COMPONENT MUST BE ASSEMBLED)

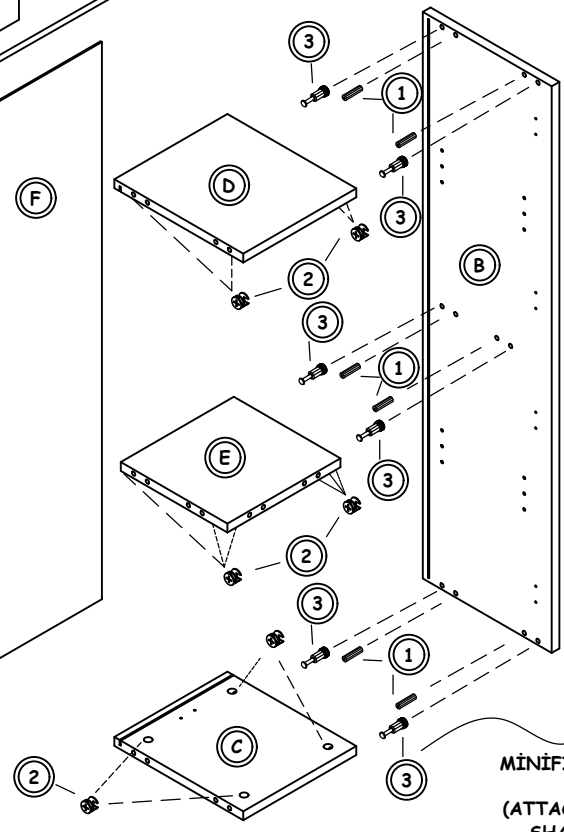

MİNİFİKS MİLİNİN DELİĞE TAKILMASI
(ATTACHING THE MINIFIX SHAFT IN THE HOLE)

3

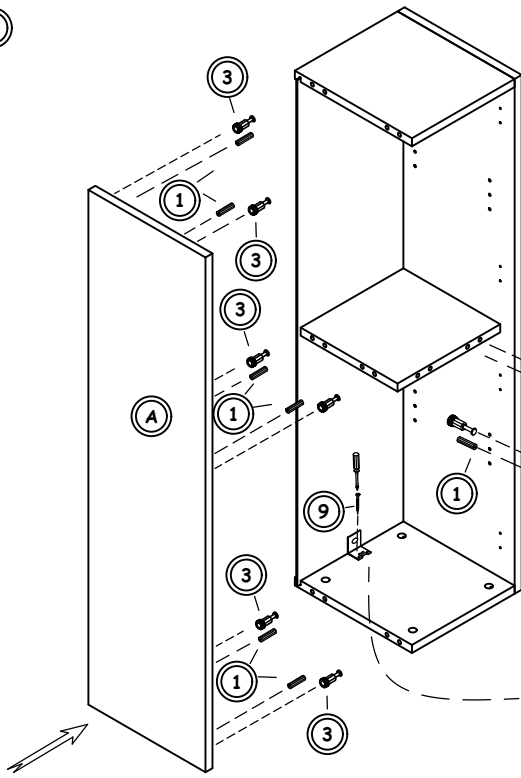

KAVELA, MİNİFİKS VE MİNİFİKS
GÖVDELERİNİ YERLEŞTİRDİKTEN SONRA
MİNİFİKS GÖVDESİNİ SIKINIZ.
(AFTER PLACING THE COVER,
MINIFIX AND MINIFIX BODY,
TIGHTEN THE MINIFIX BODY)

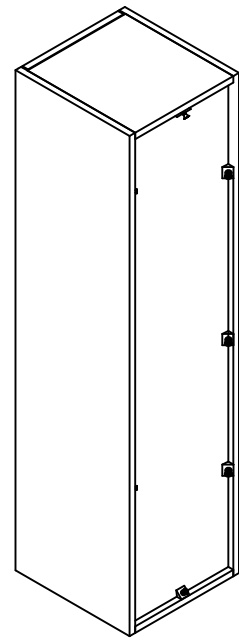
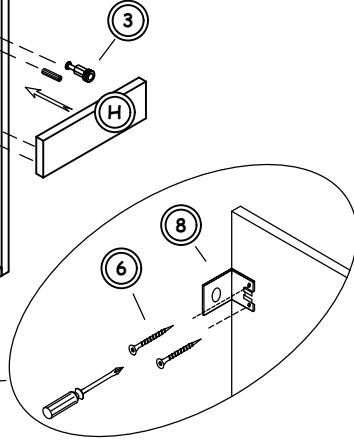

ARKALIK PİMİNİ DOLABIN
ARKALIK KISMINDA KALAN
BOŞLUĞA YERLEŞTİREREK
VİDALAYIN.
(PLACE THE BACK PIN IN
THE GAP IN THE BACK OF
THE CABINET AND SCREW
IT.)

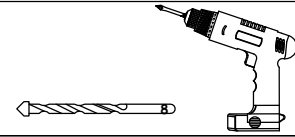
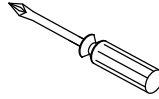
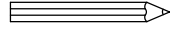
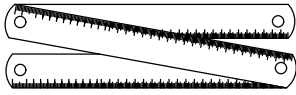
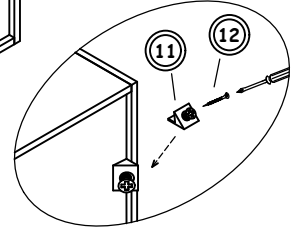

4

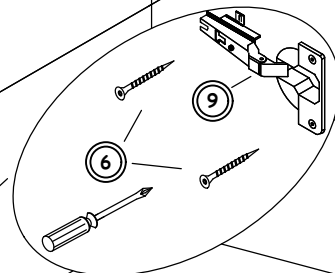
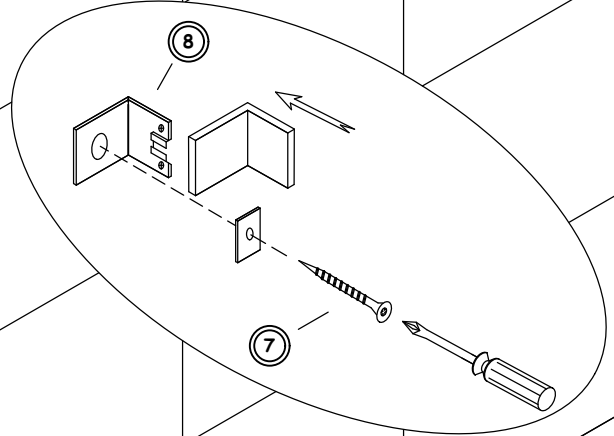
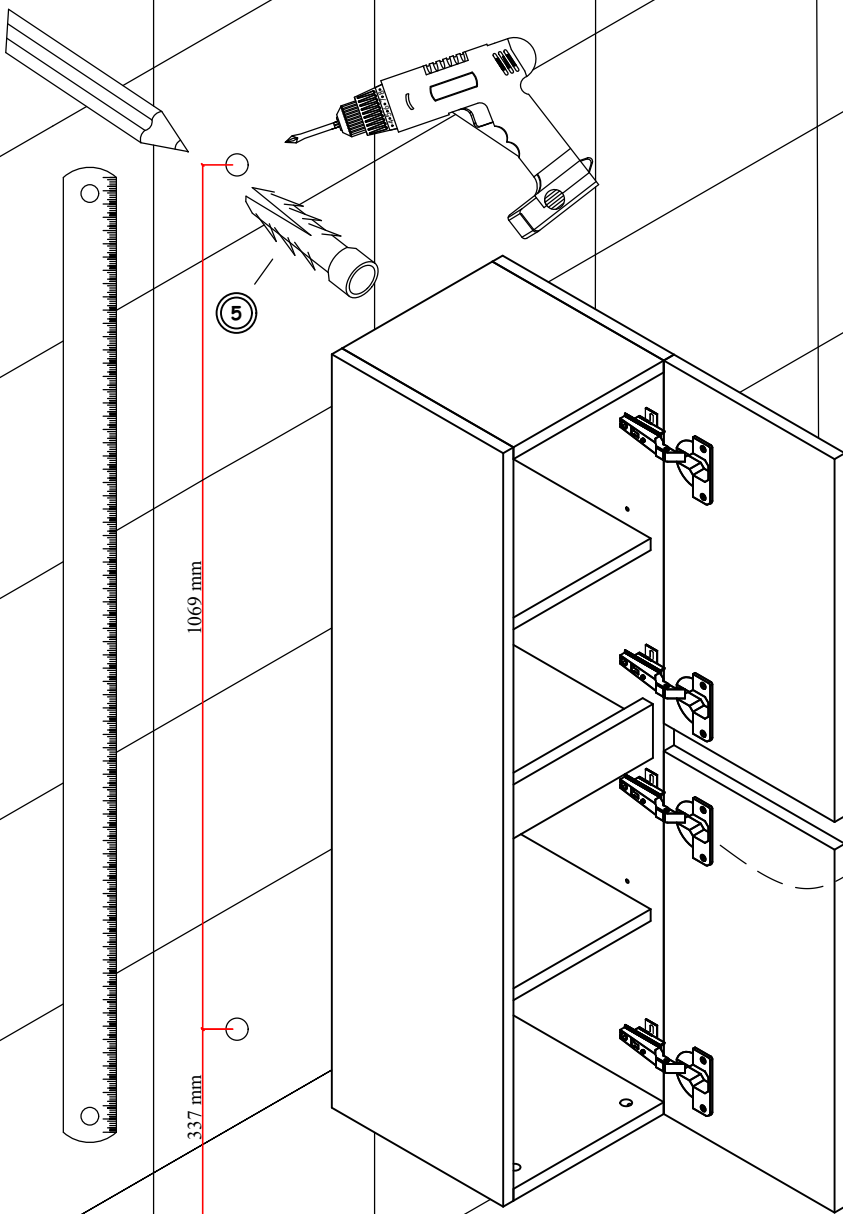

ASKI ELEMANI İÇİN DUVAR DELİKLERİNİ DARBELİ
MATKAP İLE DELİNİZ. DUVAR DELİKLERİNİ
DELDİKTEN SONRA DÜBELLERİ YERLEŞTİRİN.
PULU ARAYA KOYARAK DOLABA BAĞLADIĞINIZ
ASKI ELEMANINI DÜBELE VİDALAYIN.
(DRILL THE WALL HOLES FOR THE HANGER
COMPONENT WITH IMPACT DRILL. AFTER DRILLING
THE WALL HOLES, PLACE THE PEGS. SCREW THE
HANGER COMPONENT TO THE ANCHOR)